

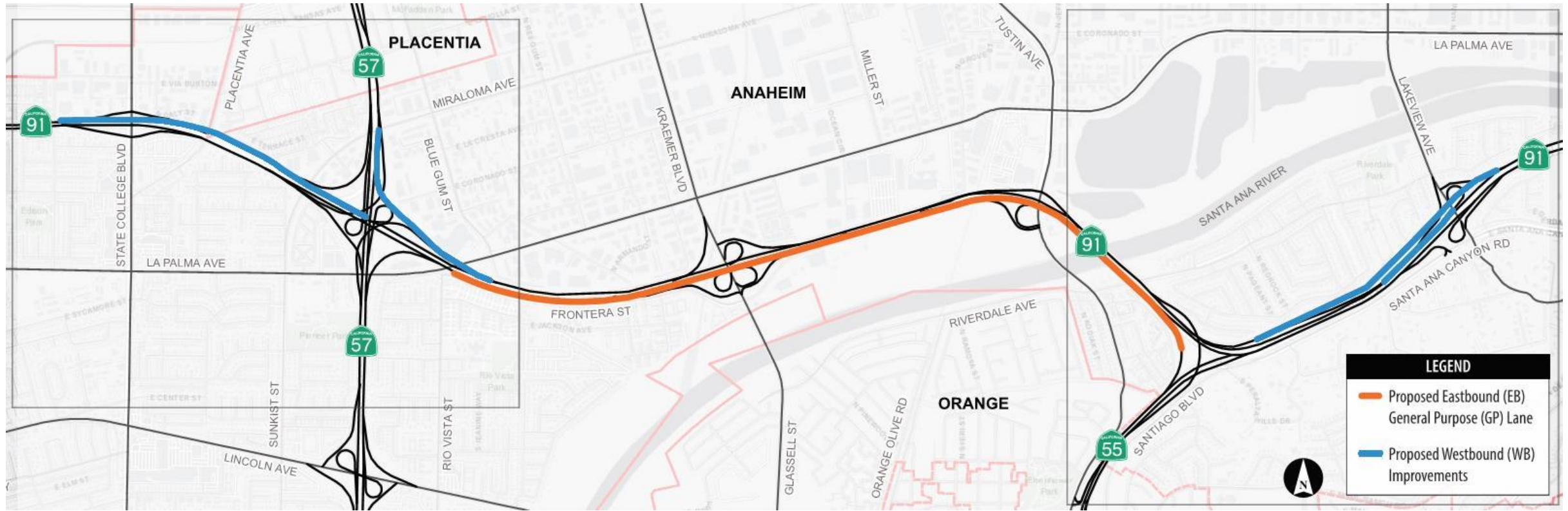

Update on State Route 91 Improvement Project from State Route 57 to State Route 55

Project Limits



Area of Improvements

State Route 91 (SR-91)/State Route 57 (SR-57) Interchange



Alternative 1 (No Build)

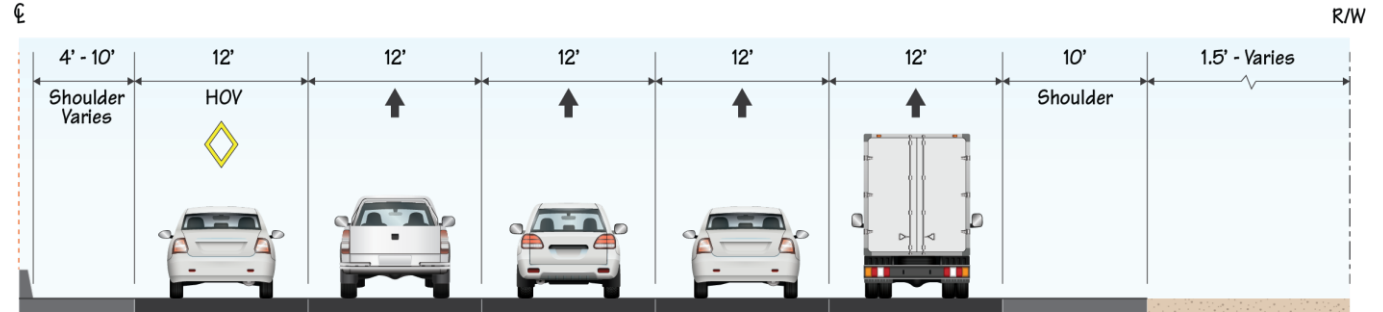

Alternative 2 (Build)

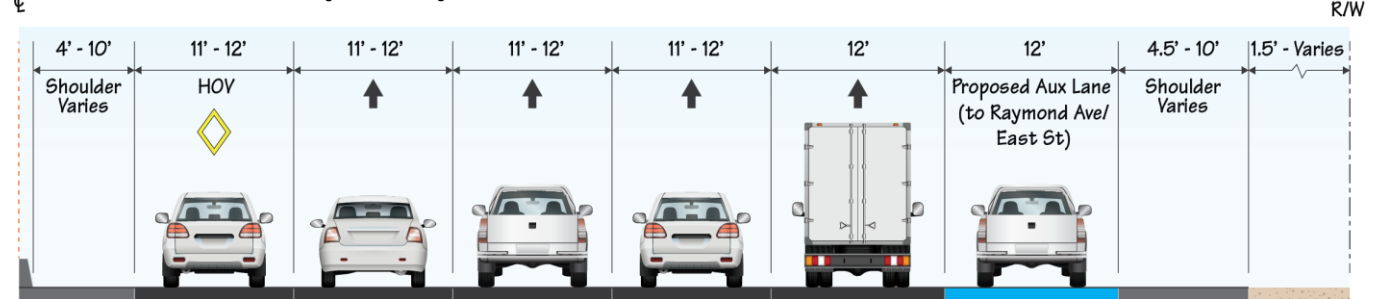

- Improve weaving from WB SR-91 to northbound and southbound (SB) SR-57
- Add an auxiliary lane from SR-57 to Raymond Avenue/East Street

LEGEND

- Proposed Eastbound (EB) General Purpose (GP) Lane
- Proposed Westbound (WB) Improvements



Area of Improvements

Between SR-57 and SR-55

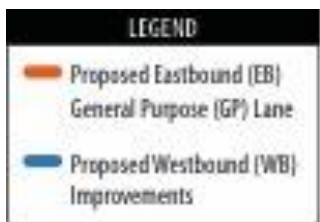
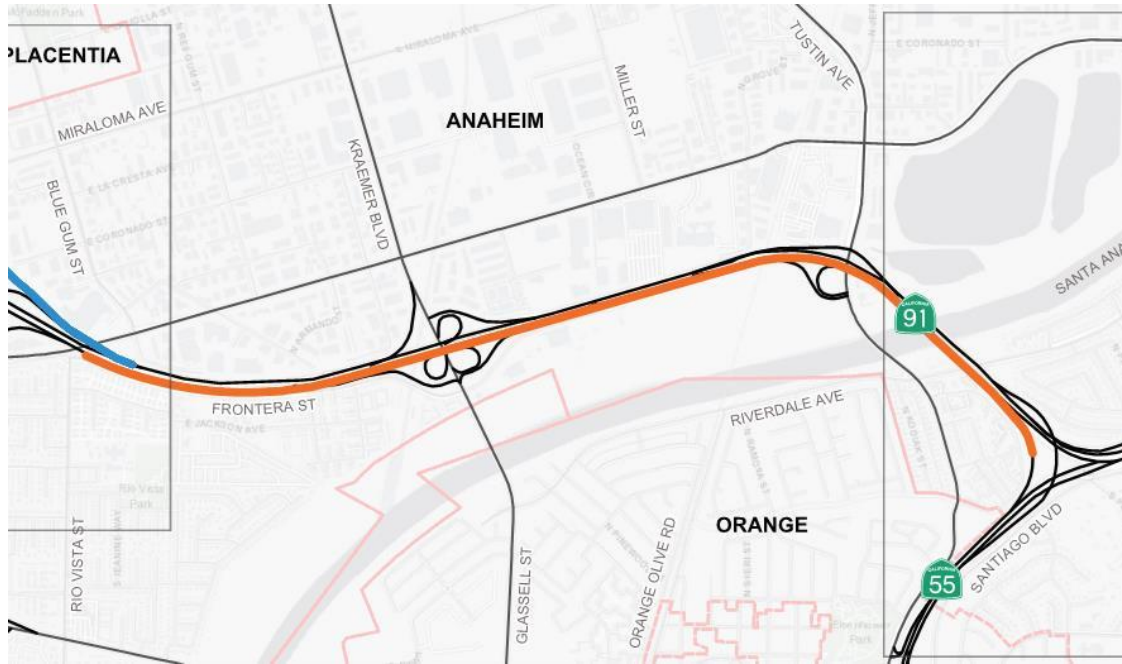

Alternative 1 (No Build)

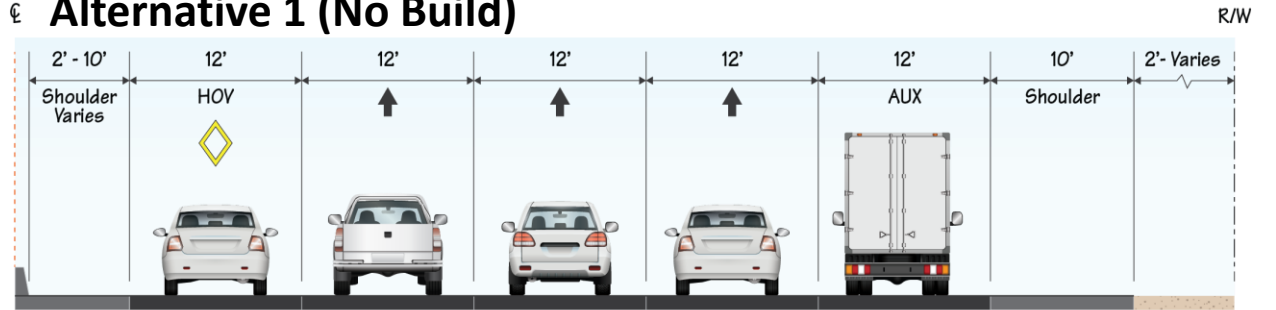

Alternative 2 (Build)

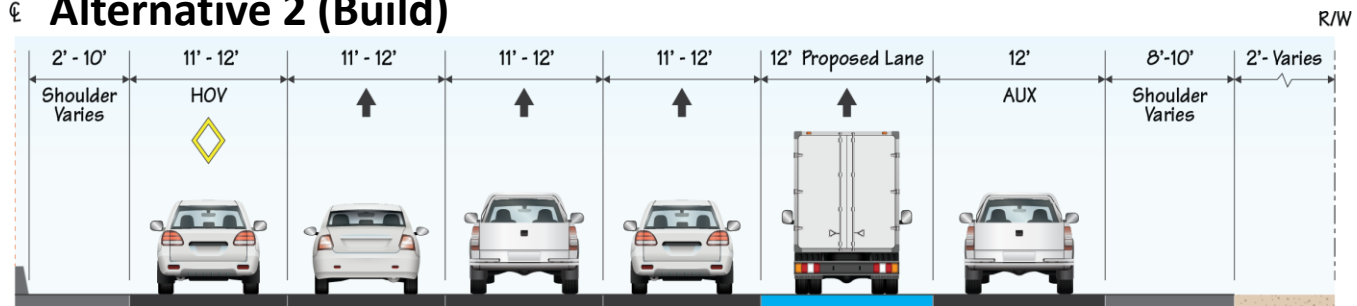

SR-91/Lakeview Avenue Interchange

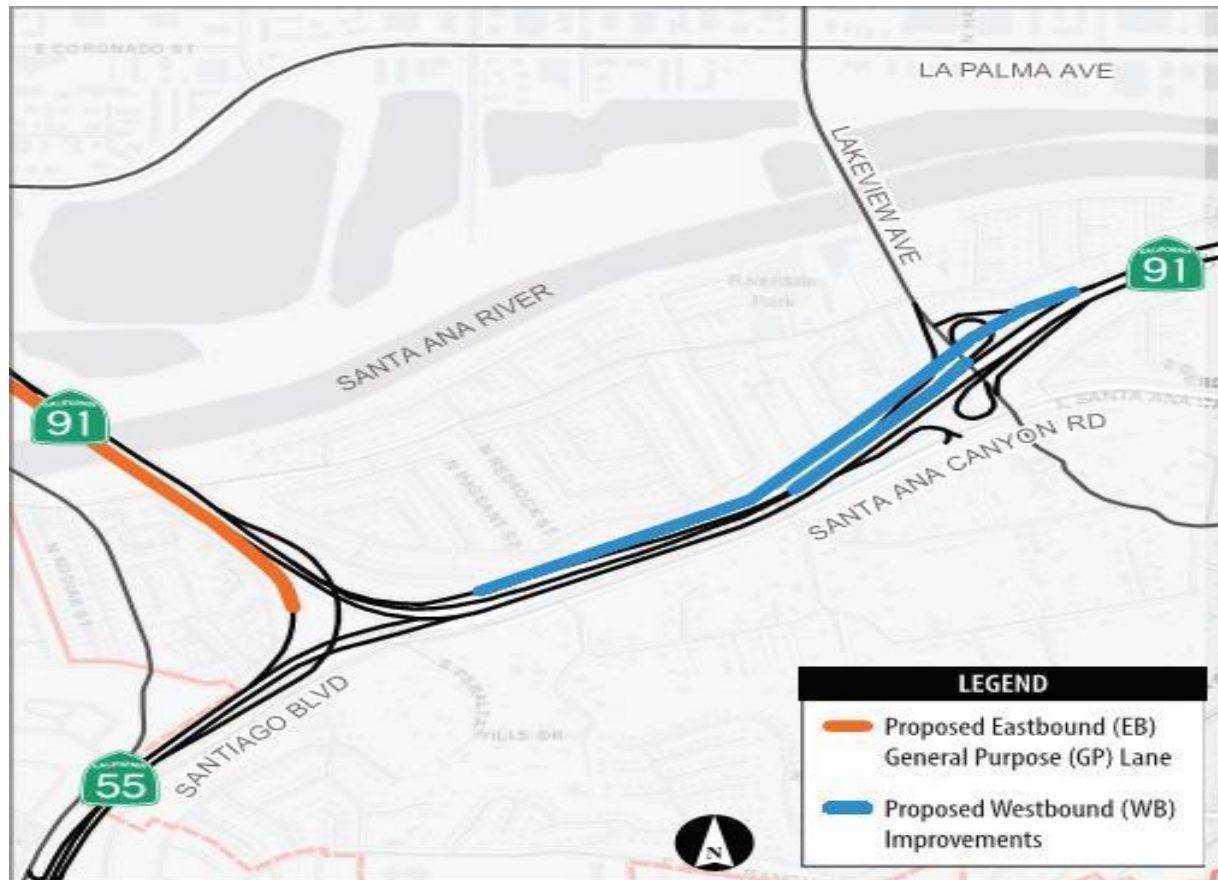

- Realign WB on-ramp to direct traffic to WB SR-91
- Add a new on-ramp from the Lakeview Bridge connecting directly to SB SR-55
- Barrier separate WB SR-91 from SB SR-55

Area of Improvements

SR-91/Lakeview Avenue Interchange

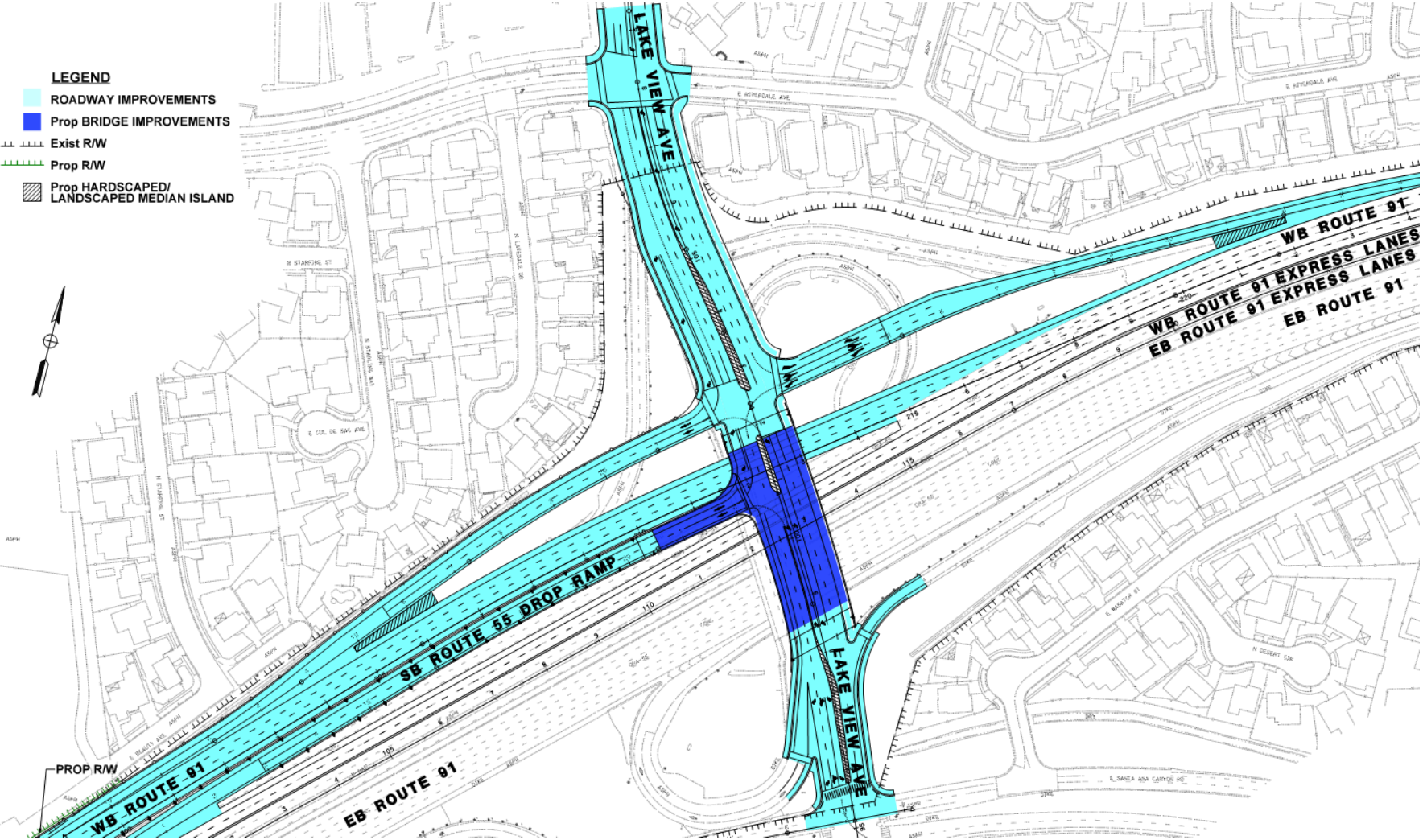

Design Year Approximate Average Daily Traffic Volumes

SR-91	Existing	Alternative 1 (No Build)	Alternative 2
WB	100,000	107,000	112,000
EB	91,000	102,000	108,000
Total	191,000	209,000	220,000

Opening Year SR-91 Freeway Mainline Travel Times (minutes)

SR-91 Peak Hour		Existing	Alternative 1 (No Build)	Alternative 2
WB	AM	20	25	20
	PM	18	29	25
EB	AM	10	18	12
	PM	14	24	16

Public Meeting, Noticing, and Outreach

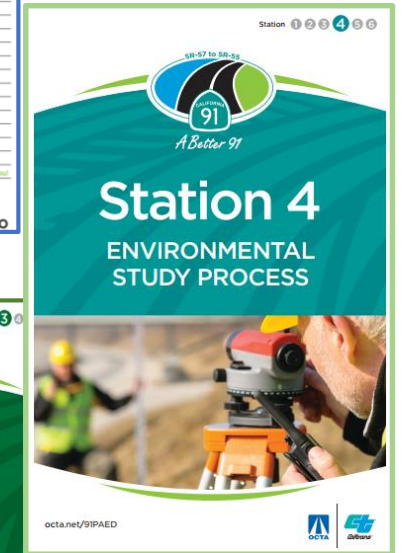
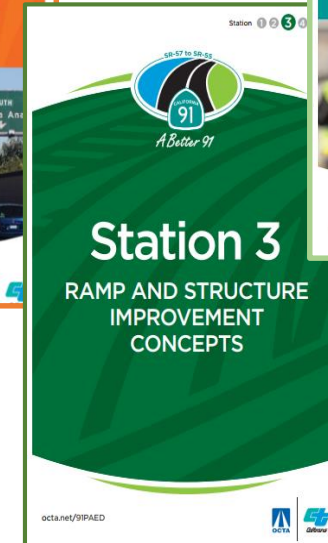
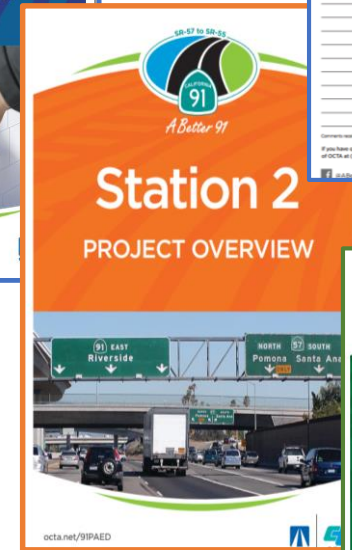
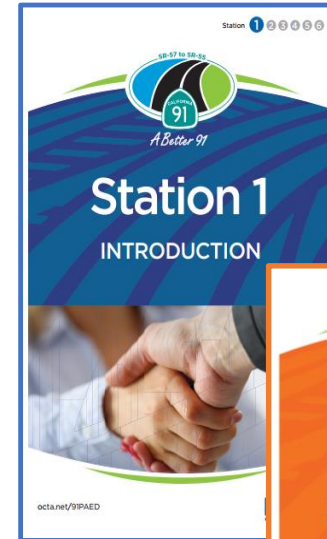
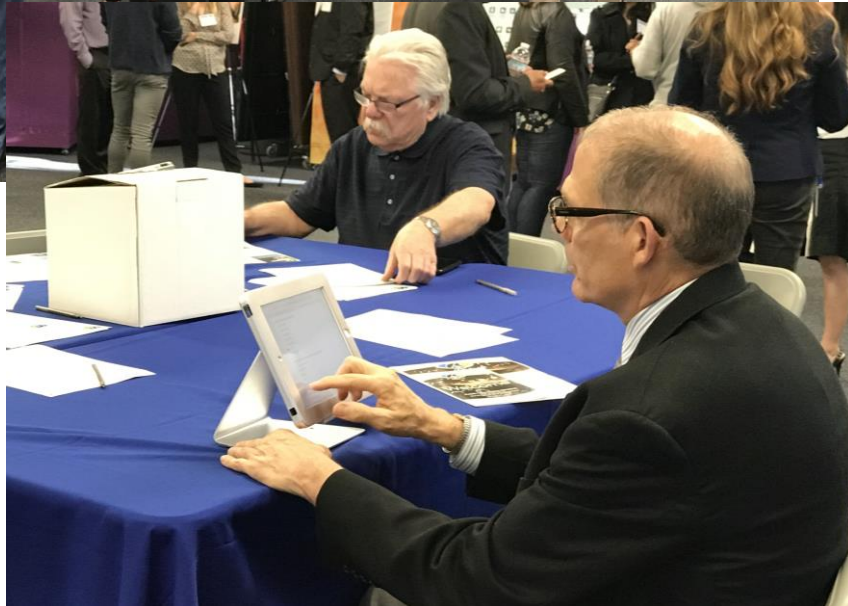

Environmental Phase Schedule

